

特性/ Features

- Long Life, High Ripple Current
- Load Life 3000 hours at 105°C
- Suitable for Frequency converters, Professional power supplies and Solar
- Compliant to the RoHS directive
- 长寿命、高纹波
- 105°C 3000小时
- 适用于变频器、专业电源和太阳能光伏等
- RoHS指令对策品



螺栓型Screw

规格表 SPECIFICATIONS

项目 Items	特性 Characteristics					
工作温度范围 Operating Temperature Range	- 40 ~ +105°C					
额定工作电压范围 Rated Working Voltage Range	350 ~ 520V					
静电容量范围 Capacitance Range	1000 ~ 15000µ F					
静电容量允许偏差 Capacitance Tolerance	±20% (20 °C, 120Hz)					
损耗角正切值 Dissipation Factor (MAX) 20°C , 120Hz	U _R (V)	350	400	450	500	520
	tanδ	0.15				
漏电流 Leakage Current (MAX)	I = 0.01C _R U _R 或5mA取小者 (20 °C , 施加额定电压5分钟后) I = 0.01C _R U _R or 5mA whichever is minimum. (at 20°C , After 5 minutes application of rated voltage) I = 漏电流 (µA) U _R = 额定电压 (V) C _R = 静电容量 (µF) Leakage Current Rated Voltage Rated Capacitance					

	使用寿命 Useful Life		负荷寿命 Load Life	耐久性特性 Endurance Test	高温无负荷特性 Shelf Life
产品寿命 Life Time	6000h	>200000h	3000	3000h	1000h
漏电流 Leakage Current	≤规定值 ≤ Specified value		≤规定值 ≤ Specified value	≤规定值 ≤ Specified value	≤规定值 ≤ Specified value
损耗角正切值变化率 tanδ Change	≤规定值的300% ≤ 300% of specified value		≤规定值的200% ≤200% of specified value	≤规定值的130% ≤130% of specified value	≤规定值的150% ≤150% of specified value
静电容量变化率 Capacitance Change	初始值± 30%以内 Within± 30% of initial value		初始值±20%以内 Within±20% of initial value	初始值±10%以内 Within±10% of initial value	初始值±15%以内 Within±15% of initial value
施加条件 Condition 施加电压 Applied Voltage 施加纹波电流 Applied Ripple Current 环境温度 Applied Temperature 失效等级 Failure Rate Level	U _R I _R 105°C ≤ 1% Failure rate	U _R 1.2× I _R 40°C ≤ 1% Failure rate	U _R I _R 105°C 0%	U _R I _R =0 105°C 0%	U _R =0 I _R =0 105°C 0% Back up to 20 °C and placed more than 24 hours. U _R to be applied for 60 min before measurement.

尺寸图 Dimensions

●常用端子型式代码：Terminal Code

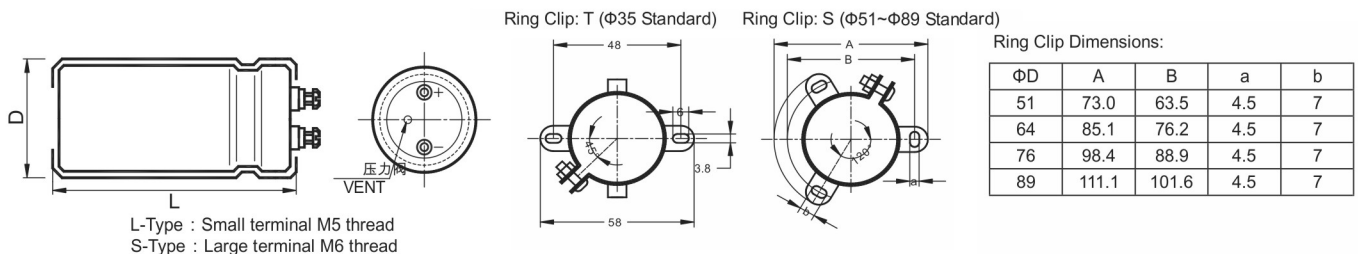

●记载以外的端子形状，请另行咨询。Please consult to us for the terminal type not displayed in content.

产品编码体系 PART NUMBER SYSTEM

●例如：Example HB 500V3300µF Φ76×130 ±20%

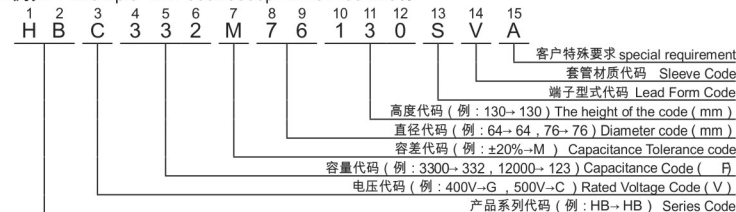

纹波电流修正系数 Rated Ripple Current Multipliers

●频率修正系数 Frequency coefficient

频率 Frequency (Hz)	50(60)	100(120)	300	1k	≥10k
系数 Coefficient	0.80	1.00	1.18	1.30	1.40

●温度修正系数 Temperature coefficient

温度 Temperature (°C)	+40	+55	+70	+85	+105
系数 Coefficient	3.30	2.85	2.40	2.00	1.00

◆ 产品一览表 Standard Ratings

WV _{DC} (Surge Voltage) (V)	Cap (μ F)	Size D x L (mm)	tan δ 20°C/120Hz	Ripple Current 105°C/120Hz Z (Arms)	Catalog Part Number
350 (400)	1000	51x80	0.15	3.7	HBH102M51080□VA
	1200	51x80	0.15	4.0	HBH122M51080□VA
	1500	51x95	0.15	4.9	HBH152M51095□VA
	1800	51x95	0.15	5.2	HBH182M51095□VA
	2200	51x115	0.15	6.2	HBH222M51115□VA
	2700	64x95	0.15	6.7	HBH272M64095□VA
	3300	64x115	0.15	8.6	HBH332M64115□VA
	3900	64x130	0.15	9.9	HBH392M64130□VA
	4700	76x115	0.15	11.4	HBH472M76115□VA
	5500	76x130	0.15	13.0	HBH552M76130□VA
	5600	76x130	0.15	13.1	HBH562M76130□VA
	6800	76x155	0.15	15.2	HBH682M76155□VA
	8200	89x130	0.15	17.7	HBH822M89130□VA
	10000	89x157	0.15	19.5	HBH103M89157□VA
	12000	89x195	0.15	23.0	HBH123M89195□VA
15000	89x220	0.15	28.0	HBH153M89220□VA	
400 (450)	1000	51x80	0.15	3.9	HBG102M51080□VA
	1200	51x95	0.15	4.6	HBG122M51095□VA
	1500	51x95	0.15	5.6	HBG152M51095□VA
	1800	51x115	0.15	6.4	HBG182M51115□VA
	2200	64x95	0.15	6.9	HBG222M64095□VA
	2700	64x115	0.15	8.2	HBG272M64115□VA
	3300	64x130	0.15	9.5	HBG332M64130□VA
	3900	76x115	0.15	10.4	HBG392M76115□VA
	4700	76x130	0.15	12.0	HBG472M76130□VA
	5600	76x155	0.15	14.0	HBG562M76155□VA
	6800	89x130	0.15	16.5	HBG682M89130□VA
	8200	89x157	0.15	18.1	HBG822M89157□VA
10000	89x195	0.15	21.7	HBG103M89195□VA	
12000	89x220	0.15	25.8	HBG123M89220□VA	
450 (500)	1000	51x95	0.15	4.2	HBE102M51095□VA
	1200	51x95	0.15	4.8	HBE122M51095□VA
	1500	51x115	0.15	5.6	HBE152M51115□VA

WV _{DC} (Surge Voltage) (V)	Cap (μ F)	Size D x L (mm)	tan δ 20°C/120Hz	Ripple Current 105°C/120Hz Z (Arms)	Catalog Part Number
450 (500)	1800	64x95	0.15	6.5	HBE182M64095□VA
	2200	64x115	0.15	7.4	HBE222M64115□VA
	2700	64x130	0.15	8.6	HBE272M64130□VA
	3300	76x115	0.15	10.2	HBE332M76115□VA
	3900	76x130	0.15	11.3	HBE392M76130□VA
	4700	76x155	0.15	12.9	HBE472M76155□VA
	5600	89x130	0.15	14.7	HBE562M89130□VA
	6800	89x157	0.15	17.8	HBE682M89157□VA
	8200	89x195	0.15	19.3	HBE822M89195□VA
	10000	89x220	0.15	22.4	HBE103M89220□VA
	500 (550)	1000	51x115	0.15	4.4
1200		51x130	0.15	4.9	HBC122M51130□VA
1500		64x95	0.15	5.7	HBC152M64095□VA
1800		64x115	0.15	6.5	HBC182M64115□VA
2200		64x130	0.15	7.5	HBC222M64130□VA
2700		76x115	0.15	8.7	HBC272M76115□VA
3300		76x130	0.15	10.0	HBC332M76130□VA
3900		76x155	0.15	11.5	HBC392M76155□VA
4700		89x157	0.15	13.5	HBC472M89157□VA
5600		89x157	0.15	14.8	HBC562M89157□VA
520 (570)	6800	89x195	0.15	17.0	HBC682M89195□VA
	8200	89x235	0.15	19.7	HBC822M89235□VA
	1000	51x115	0.15	4.4	HB2102M51115□VA
	1200	51x130	0.15	5.0	HB2122M51130□VA
	1500	64x115	0.15	5.7	HB2152M64115□VA
	1800	64x130	0.15	6.7	HB2182M64130□VA
	2200	76x115	0.15	7.8	HB2222M76115□VA
	2700	76x130	0.15	9.1	HB2272M76130□VA
	3300	76x155	0.15	11.2	HB2332M76155□VA
	3900	89x130	0.15	12.3	HB2392M89130□VA
	4700	89x157	0.15	14.2	HB2472M89157□VA
5600	89x170	0.15	15.7	HB2562M89170□VA	
6800	89x195	0.15	18.1	HB2682M89195□VA	

*产品编码中□内为产品端子引出型式代码
*□Enter the appropriate terminal code

*记载之外的体积，请另行咨询。
*Please ask for advice for other sizes.

*铝电解电容器由于承受纹波电流而发热，随着温升而发生性能劣化。请在使用中降低产品承受的纹波电流。
*Aluminum electrolytic capacitor will emit heat when ripple current is applied, the performance will deteriorate when temp. rises. Please reduce the ripple current when using capacitor.

Note: All design and specification are for reference only and is subject to change without prior notice. If any doubt about safety for your application, please contact KNSCHA immediately for technical assistance before purchase.
备注：以上所提供的设计及特性参数仅供参考，任何修改不作预先通知。如果在使用上有疑问，请再购买前与科尼盛联系，以便我们提供技术上的服务和协助。